

HSG04-POLETOP

Pole top mount for HSG04, HSG05

DESCRIPTION

HSG04-PoleTop is a mount with swivel for the HSG04 and HSG05 fixed camera housings. It was designed to fit on a horizontal surface, typically a pole top.



Mechanical

Materials	SPCC
Dimensions (L x W x H)	126 x 126 x 80 (mm)
Color	White
Max. Load	10 kg
Weight	0.15 kg

Ordering Information

HSG04-PoleTop	Pole top mount for HSG04, HSG05
HSG04	Outdoor Wiper housing for a fixed box camera
HSG05	Outdoor fixed housing, 90-260VAC

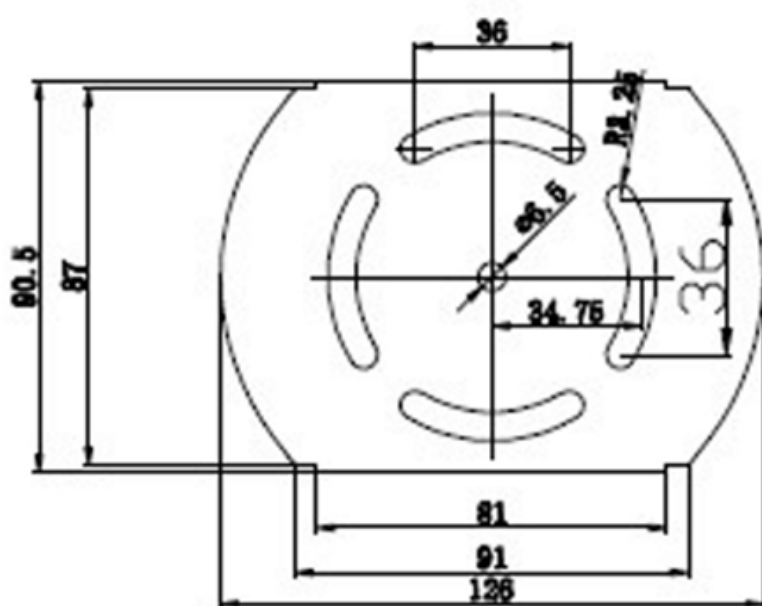
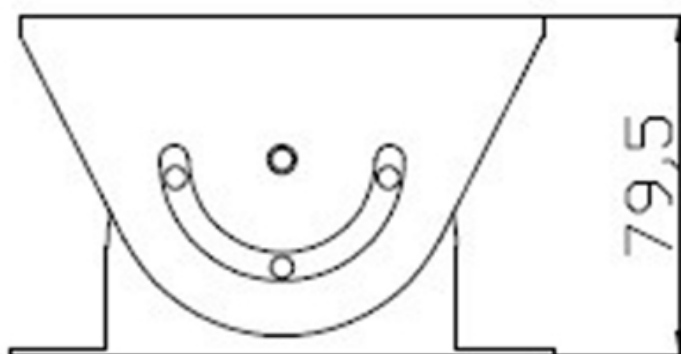
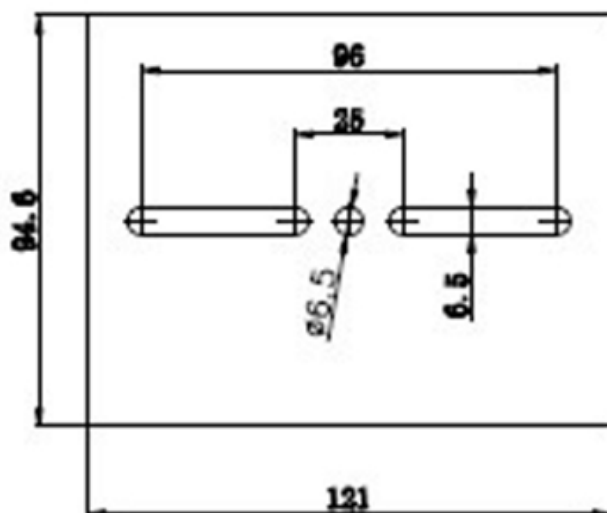

RELATED



TKH Security HSG04

Outdoor Wiper housing for a fixed box camera



TKH Security HSG05

Outdoor fixed housing, 90-260VAC