

# SA-FIX W (EOL)

316L all weather fixed IP camera with wiper

## DESCRIPTION

\*\*\* Discontinued. Replaced by SA3-FIX W \*\*\*

The SA-FIX W camera housing is a rugged corrosion proof camera housing designed for use in onshore, offshore, marine and heavy industrial environments. The camera housing is constructed from electro-polished 316L stainless steel for maximum corrosion protection and is fitted with an 316L sun-shield, a thermostatically controlled heater element, and a integrated wiper. The housing is not sold separately, it is only available in combination with a Siquira daylight camera module, such as the BC822v2H3-AS or the BC980H2-AS, and an interface (INT-RJ/SM/MM).

## FEATURES

---

Corrosion protected 316L stainless-steel

---

Integrated wiper

---

Integrated power supply (24, 115 or 230 Vac)

---

Low maintenance

---

Integrated heater

---

Electro-polished 316L sun-shield included

---

Washer optional

---



## Description

Corrosion free 316L construction

(c) 20240802

#### Mechanical

Ingress protection rating	IP66/ IP67
Impact rating (casing)	IK10
Body material	Electro-polished 316L stainless steel
Sunshield	Standard
Operating temperature	-20 °C to +75 °C (-4 °F to +167 °F)
Cable entry	2x M20
Weight	8 kg

#### Electrical

Power rating	SA-FIX24W	SA-FIX115W	SA-FIX230W
	24 Vac +/-10%	115 Vac +/-10%	230 Vac +/-10%
	50/60Hz	50/60Hz	50/60Hz
Internal Heater	Standard		
- Heater control	On: 12°C +/- 4°C; Off: 20°C +/- 3°C		
- Heater power dissipation	10 W		
Wiper	Standard		
- Wiper dissipation	6 W		
Washer	Optional (SA-WP10)		

#### Ordering information

SA-FIX24W	Safe Area Fixed Camera 316L 24VAC, Wiper
SA-FIX115W	Safe Area Fixed Camera 316L 115VAC, Wiper
SA-FIX230W	Safe Area Fixed Camera 316L 230VAC, Wiper

#### Maintenance kits

EX/SA-MK Wiper	Maintenance kit for the wiper: Rubber blade and support
EX/SA-Wiper	Replacement for Stainless steel wiper (complete assembly)
SA-MK F	Maintenance kit SA Fixed camera: O-Ring, screws, 2 cable glands, desiccant bags

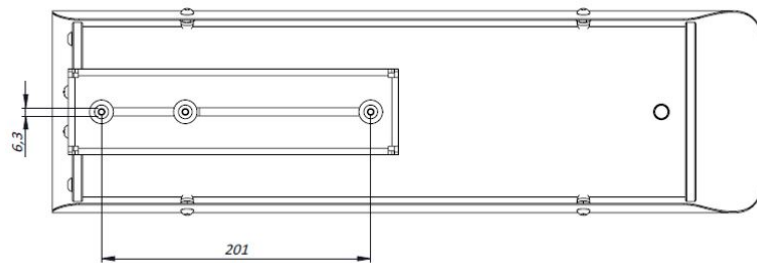
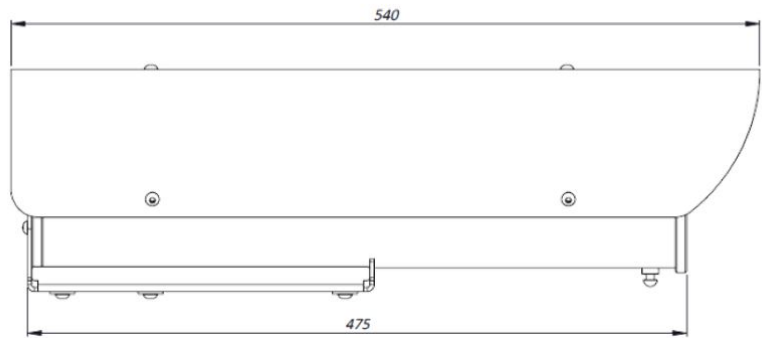
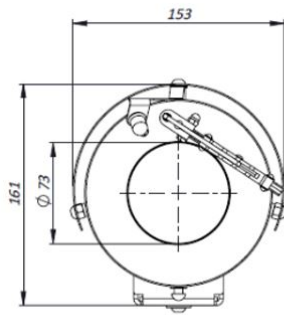

Housing	Optical camera	Thermal camera			Interface				
	BC822v2H3-SA	TC(R1)-336	TC(R1)-640	INT-RJ	INT-RJ5 INT-RJ10	INT-SM	INT-SM5 INT-SM10	INT-MM	INT-MM5 INT-MM10
SA-FIX24	✓			✓		✓		✓	
SA-FIX24W	✓			✓		✓		✓	
SA-FIX24T	✓	✓	✓	✓		✓		✓	
SA-PTZ24	✓			✓					
SA-PTZ24T		✓	✓	✓					
SA-PTZ24D	✓	✓	✓	✓					

*This charts also applies to the SA cameras versions for 115 Vac and 230 Vac.*

## RELATED



### Siqura BC822v2H3-AS

Assembly 33x zoom IP camera, 3MP, AF, Day/night, H.265/H.264



### TKH Security BC980H2-AS

8MP IP Box camera with integrated 22x zoom lens



### Siqura SA mounting accessories

316L Mounting accessories for the SA-FIX and SA-PTZ series



### Siqura INT-RJ / INT-SM / INT-MM (EoL)

Network Interface and cable tail of the Siqura SA or EX cameras