

WM27

Wall mount, for PD9x0

DESCRIPTION

The WM27 is a wall mount mount for the PD9x0 cameras, or any camera that supports connection via NPT 1.5" threaded mounting.

FEATURES

Aluminium



Mechanical

Materials	Aluminium (ADC12)
Finishing	Glass paint
Dimensions (L x W x H)	348 x 104 x 139 mm
Color	White
Max. Load	10 kg
Weight	1.5 kg

Ordering Information

WM27	Wall mount, for PD9x0
JB27	Junction box, for WM01A, WM27
PM27JB	Pole mount, for JB27
WM27JB	Corner mount, for JB27

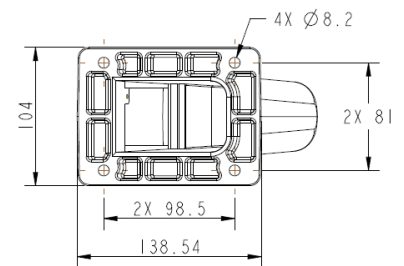
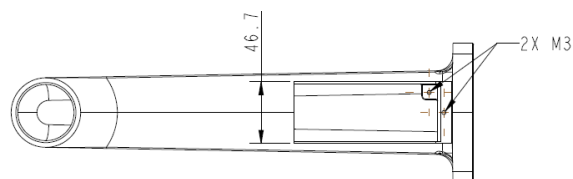
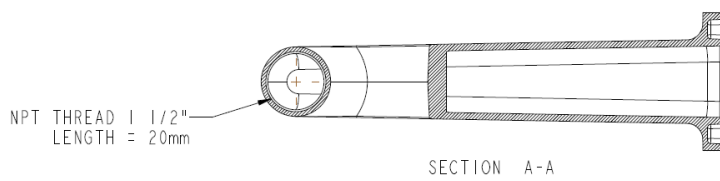
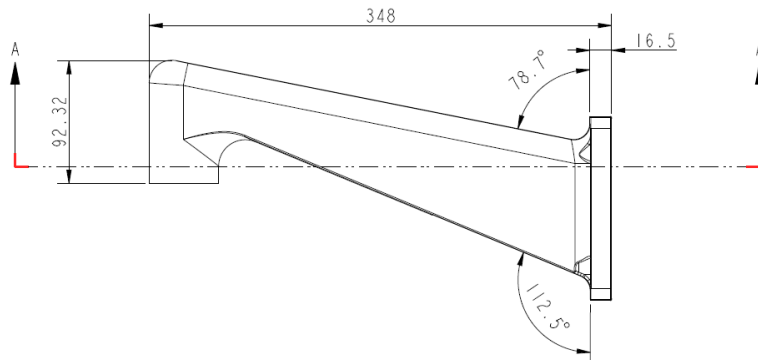

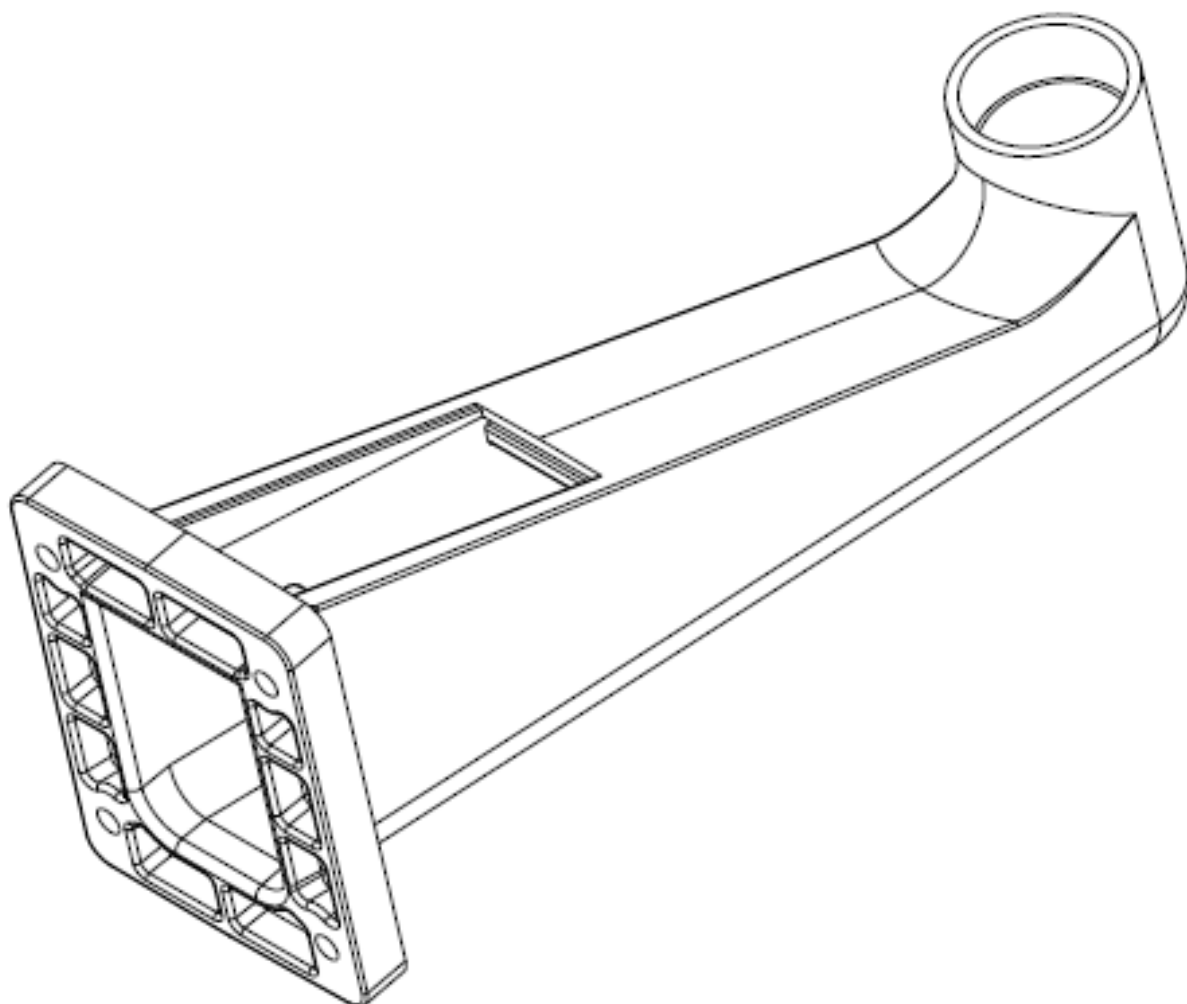

RELATED



TKH Security PM01
Pole mount, for WM01A, WM27



TKH Security WM05
Corner mount, for WM01A, WM27



TKH Security JB27
Junction box, for WM01A, WM27



TKH Security TA27
Tube adapter/pendant mount for FD810, FD820v2, FD910, FD950, FD980, FD360



Siquira PD900 (EOL)
3 MP High-speed PTZ dome camera 30x zoom



Siquira PD910 (EOL)
3 MP high-speed PTZ camera with 40x zoom, IR



TKH Security PD950
5MP intelligent IP outdoor PTZ camera 40x zoom, IR, Wiper



TKH Security PD980
8 MP high-speed PTZ camera with 31x zoom, IR, Wiper



TKH Security PD950DC
5 MP High-speed outdoor PTZ dome camera 40x zoom



TKH Security PD950NW
5MP intelligent IP outdoor PTZ camera 40x zoom, IR